



PUBLIC NOTICE

US Army Corps
of Engineers
New York District
Jacob K. Javits Federal Building
New York, N.Y. 10278-0090
ATTN: Regulatory Branch

In replying refer to:
Public Notice Number: **NAN-2024-00441-EMI**
Issue Date:
Expiration Date:

To Whom It May Concern:

The New York District, Corps of Engineers has received an application for a Department of the Army permit pursuant to Section 10 of the Rivers and Harbors Act of 1899 (33 U.S.C. 403).

APPLICANT: New York Waterway
4800 Avenue at Port Imperial
Weehawken, New Jersey 07086

ACTIVITY: Reconstruction of a Ferry Landing

WATERWAY: Hudson River

LOCATION: 1 14th Street, City of Hoboken, Hudson County, New Jersey

A detailed description and plans of the applicant's activity are enclosed to assist in your review.

The decision whether to issue a permit will be based on an evaluation of the probable impact including cumulative impacts of the proposed activity on the public interest. That decision will reflect the national concern for both protection and utilization of important resources. The benefit which reasonably may be expected to accrue from the proposal must be balanced against its reasonably foreseeable detriments. All factors which may be relevant to the proposal will be considered including the cumulative effects thereof; among those are conservation, economics, aesthetics, general environmental concerns, wetlands, historic properties, fish and wildlife values, flood hazards, floodplain values, land use, navigation, shoreline erosion and accretion, recreation, water supply and conservation, water quality, energy needs, safety, food and fiber production, mineral needs, considerations of property ownership and, in general, the needs and welfare of the people.

The Corps of Engineers is soliciting comments from the public; Federal, state, and local agencies and officials; Indian Tribes; and other interested parties in order to consider and evaluate the impacts of this proposed activity. Any comments received will be considered by the Corps of Engineers to determine whether to issue, modify, condition or deny a permit for this proposal. To make this decision, comments are used to assess impacts on endangered species, historic properties, water quality, general environmental effects, and the other public interest factors listed above. Comments are used in preparation of an Environmental Assessment and/or an Environmental Impact Statement pursuant to the National Environmental Policy Act. Comments are also used to determine the need for a public hearing and to determine the overall public interest of the proposed activity.

ALL COMMENTS REGARDING THE PERMIT APPLICATION MUST BE PREPARED IN WRITING AND EMAILED TO REACH THIS OFFICE BEFORE THE EXPIRATION DATE OF THIS NOTICE,
otherwise, it will be presumed that there are no objections to the activity.

CENAN-OP-RE
PUBLIC NOTICE NO. NAN-2024-00441-EMI

Comments submitted in response to this notice will be fully considered during the public interest review for this permit application. Comments provided will become part of the public record for this permit application. All written comments, including contact information, will be made a part of the administrative record, available to the public under the Freedom of Information Act. The Administrative Record, or portions thereof, may also be posted on a Corps of Engineers internet web site. Due to resource limitations, this office will normally not acknowledge the receipt of comments or respond to individual letters of comment.

Any person may request, in writing, before this public notice expires, that a public hearing be held to collect information necessary to consider this application. Requests for public hearings shall state, with particularity, the reasons why a public hearing should be held. It should be noted that information submitted by email is considered just as carefully in the permit decision process and bears the same weight as that furnished at a public hearing.

Our preliminary determination is that the activity for which authorization is sought herein is not likely to affect any Federally endangered or threatened species or their critical habitat. However, pursuant to Section 7 of the Endangered Species Act (16 U.S.C. 1531), the District Engineer is consulting with the appropriate Federal agency to determine the presence of and potential impacts to listed species in the project area or their critical habitat.

The Magnuson-Stevens Fishery Conservation and Management Act, as amended by the Sustainable Fisheries Act (Public Law 104-267), requires all Federal agencies to consult with the National Oceanic and Atmospheric Administration Fisheries Service (NOAA/FS) on all actions, or proposed actions, permitted, funded, or undertaken by the agency, that may adversely affect Essential Fish Habitat (EFH). The proposed work, fully described in the attached work description, could cause the disruption of habitat for various lifestages of some EFH-designated species as a result of a temporary increase in turbidity during construction. However, the New York District has made the preliminary determination that the site-specific adverse effects are not likely to be substantial because it is expected that fish populations would avoid the small area of disturbance. Further consultation with NOAA/FS regarding EFH impacts and conservation recommendations is being conducted and will be concluded prior to the final decision.

Based upon a review of the latest published version of the National Register of Historic Places, there are no known sites eligible for, or included in, the Register within the permit area. Presently unknown archeological, scientific, prehistorical, or historical data may be lost by work accomplished under the required permit.

Reviews of activities pursuant to Section 404 of the Clean Water Act will include application of the guidelines promulgated by the Administrator, U.S. Environmental Protection Agency, under authority of Section 404 (b) of the Clean Water Act and the applicant will obtain a water quality certificate or waiver from the appropriate state agency in accordance with Section 401 of the Clean Water Act prior to a permit decision.

Pursuant to Section 307 (c) of the Coastal Zone Management Act of 1972 as amended [16 U.S.C. 1456 (c)], for activities under consideration that are located within the coastal zone of a state which has a federally approved coastal zone management program, the applicant has certified in the permit application that the activity complies with, and will be conducted in a manner that is consistent with, the approved state coastal zone management program. By this public notice, we are requesting the state's concurrence with, objection to, or waiver of the applicant's certification. No permit decision will be made until one of these actions occurs. For activities within the coastal zone

CENAN-OP-RE
PUBLIC NOTICE NO. NAN-2024-00441-EMI

of New Jersey State, the applicant's certification and accompanying information is available from the New Jersey Department of Environmental Protection, Coastal Management Program, P.O. Box 418, 401 E. State Street, Trenton, NJ, 08625, Telephone (609) 633-2201. Comments regarding the applicant's certification, and copies of any letters to this office commenting upon this proposal, should be so addressed.

In addition to any required water quality certificate and coastal zone management program concurrence, the applicant has obtained or requested the following governmental authorization for the activity under consideration:

- New Jersey Department of Environmental Protection

It is requested that you communicate the foregoing information concerning the activity to any persons known by you to be interested and who did not receive a copy of this notice. Please send all comments and questions concerning this application to Christopher.W.Minck@usace.army.mil.

In order for us to better serve you, please complete our Customer Service Survey located at <http://www.nan.usace.army.mil/Missions/Regulatory/CustomerSurvey.aspx>.

For more information on New York District Corps of Engineers programs, visit our website at <http://www.nan.usace.army.mil>.

FOR AND IN BEHALF OF
Stephan A. Ryba
Chief, Regulatory Branch

Enclosures

WORK DESCRIPTION

The permit applicant, New York Waterway, has requested Department of the Army (DA) authorization for reconstruction of a new ferry terminal on the north side of the 14th Street Pier in the Hudson River in the City of Hoboken, Hudson County, New Jersey.

The proposed work would involve the following:

Removal of the existing 20-foot-wide by 20-foot-long steel barge, ramp and eight (8) associated steel mooring piles. Install a new 10-foot-wide by 65-foot-long ramp from the 14th Street Pier leading to a 27-foot-wide by 80-foot-long steel barge anchored by four (4) 36-inch diameter hollow steel pipe piles. Two (2) additional 36-inch hollow steel pipe piles with donut fendering will be installed.

The applicant has avoided, minimized, and mitigated for potential impacts proposed to the maximum extent practicable by relocating the pier further waterward into deeper water, to avoid the need for dredging. The applicant will utilize a turbidity curtain around the construction area, as practicable to minimize the spread of turbidity in the waterway. Additionally, the applicant will utilize a vibratory hammer to minimize noise generated during pile driving, as practicable.

The purpose of the project is to replace the ferry landing to improve and expand ferry service at the 14th Street Pier.



<p>PURPOSE: FERRY LANDING BARGE REPLACEMENT</p> <p>DATUM: NAVD88</p> <p>ADJACENT OWNERS:</p> <p>1. SEE ATTACHED LIST.</p>	<p>HOBOKEN 14TH ST FERRY LANDING BARGE REPLACEMENT</p> <p>APPLICANT: DONALD LILOIA 4800 AVENUE AT PORT IMPERIAL WEEHAWKEN, NJ 07086</p> <p>AGENT: M.G. McLaren Engineering Group 530 Chestnut Ridge Road Woodcliff Lake, NJ 07677</p>	<p>VICINITY MAP</p> <p>IN: HUDSON RIVER AT: HOBOKEN COUNTY OF:HOBOKEN STATE:NJ</p> <p>SHT 01 OF 09 03/15/2024</p>
---	---	---

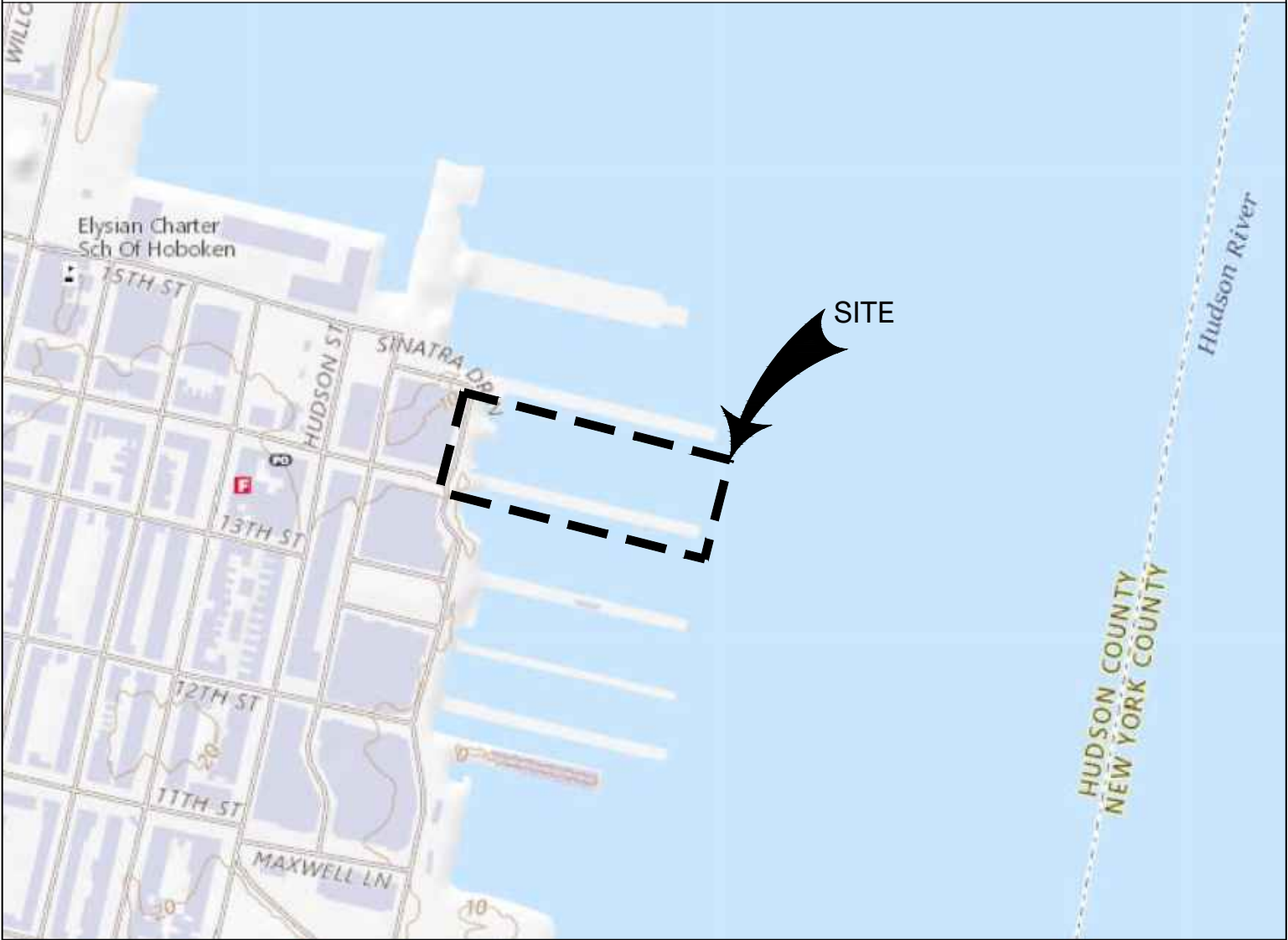
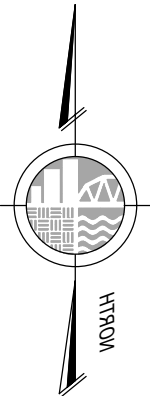

<p>PURPOSE: FERRY LANDING BARGE REPLACEMENT</p> <p>DATUM: NAVD88</p> <p>ADJACENT OWNERS:</p> <p>1. SEE ATTACHED LIST.</p>	<p>HOBOKEN 14TH ST FERRY LANDING BARGE REPLACEMENT</p> <p>APPLICANT: DONALD LILOIA 4800 AVENUE AT PORT IMPERIAL WEEHAWKEN, NJ 07086</p> <p>AGENT: M.G. McLaren Engineering Group 530 Chestnut Ridge Road Woodcliff Lake, NJ 07677</p>	<p>LOCATION MAP</p> <p>IN: HUDSON RIVER AT: HOBOKEN COUNTY OF:HOBOKEN STATE:NJ</p> <p>SHT 02 OF 09 03/15/2024</p>
---	---	---

TIDAL DATUM			
CONTROL ELEVATION		ELEVATION (ft)	
		MLLW	NAVD88
FEMA ZONE - ZONE AE EL 9			
MEAN HIGHER-HIGH WATER	MHHW	5.043	2.311
MEAN HIGH WATER	MHW	4.800	2.070
NORTH AMERICA VERTICAL DATUM OF 1988	NAVD88	2.733	0.000
MEAN SEA LEVEL	MSL	2.569	-0.162
NATIONAL GEODETIC VERTICAL DATUM OF 1929	NGVD29	1.647	-1.086
MEAN LOW WATER	MLW	0.157	-2.574
MEAN LOWER-LOW WATER	MLLW	0.000	-2.733

- NOTES:
- 1. PROJECT HORIZONTAL DATUM: NORTH AMERICAN DATUM OF 1983 (NAD83), NEW JERSEY STATE PLANE.
 - 2. PROJECT VERTICAL DATUM: NORTH AMERICAN VERTICAL DATUM OF 1988 (NAVD88).
 - 3. ELEVATIONS SHOWN IN FEET.
 - 4. TIDAL INFORMATION WAS OBTAINED FROM NATIONAL OCEANIC AND ATMOSPHERIC ADMINISTRATION (NOAA) VDATUM V4.6 "NEW JERSEY/ NEW YORK/ CONNECTICUT - NORTHERN NJ, NY HARBOR, WESTERN LONG ISLAND SOUND.
 - 5. DESIGN WATER ELEVATIONS PRESENTED IN THE ABOVE TABLE ARE TAKEN FROM THE CLOSEST NOAA OBSERVATION STATION AT THE BATTERY, NY (STATION 8518750)
LATITUDE: 40° 42' N
LONGITUDE: 74° 0.9' W

<p>PURPOSE: FERRY LANDING BARGE REPLACEMENT</p> <p>DATUM: NAVD88</p> <p>ADJACENT OWNERS:</p> <p>1. SEE ATTACHED LIST.</p>	<p>HOBOKEN 14TH ST FERRY LANDING BARGE REPLACEMENT</p> <p>APPLICANT: DONALD LILOIA 4800 AVENUE AT PORT IMPERIAL WEEHAWKEN, NJ 07086</p> <p>AGENT: M.G. McLaren Engineering Group 530 Chestnut Ridge Road Woodcliff Lake, NJ 07677</p>	<p>TIDAL DATUM CHART</p> <p>IN: HUDSON RIVER AT: HOBOKEN COUNTY OF:HOBOKEN STATE: NJ</p> <p>SHT 03 OF 09 03/15/2024</p>
---	---	---

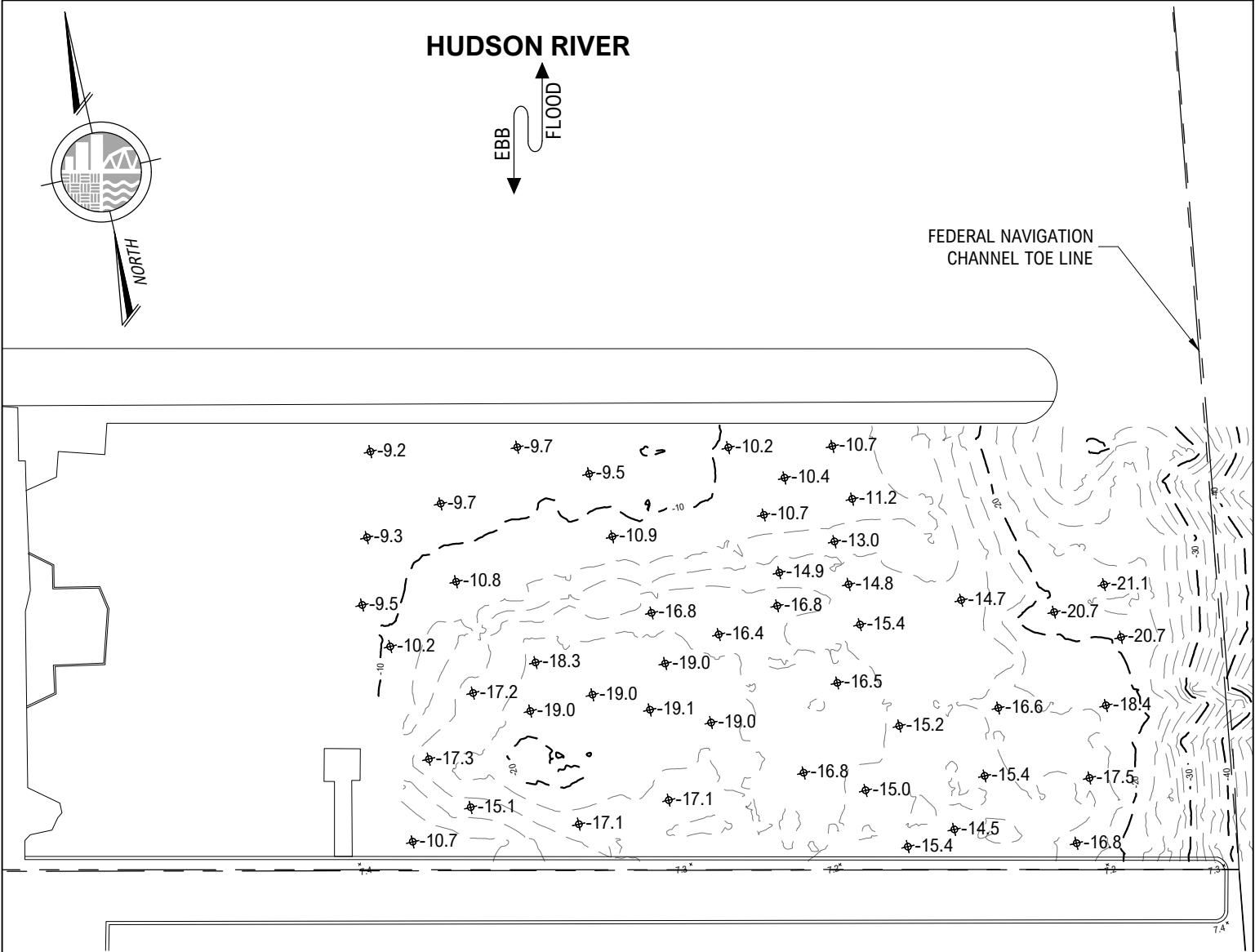

NOTES:

- 1. THE INFORMATION PRESENTED ON THIS DRAWING REPRESENTS THE RESULTS OF THE FIELD SURVEY PERFORMED ON JANUARY 17, 2024 AND CAN ONLY BE CONSIDERED AS THE GENERAL CONDITIONS AT THE TIME OF THE SURVEY.
- 2. HYDROGRAPHIC SURVEY DATA WAS COLLECTED WITH A SONARMITE HYDROLITE-TM SINGLE BEAM ECHOSOUNDER AND A TRIMBLE R8 GNSS. DATA PROCESSED WITH AUTODESK CIV3D.
- 3. COORDINATE SYSTEM: NAD83 NEW JERSEY STATE PLANE FT
- 4. VERTICAL DATUM: NORTH AMERICAN VERTICAL DATUM OF 1988 (NAV88) FT

LEGEND:

- — — MAJOR CONTOUR
- - - MINOR CONTOUR
- ⬢ 0.00 SPOT ELEVATION

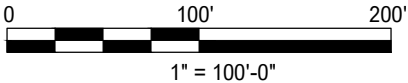

PURPOSE: FERRY LANDING BARGE REPLACEMENT

DATUM: NAVD88

ADJACENT OWNERS:

1. SEE ATTACHED LIST.

HOBOKEN 14TH ST FERRY LANDING BARGE REPLACEMENT

APPLICANT: DONALD LILOIA
4800 AVENUE AT PORT IMPERIAL
WEEHAWKEN, NJ 07086

AGENT: M.G. McLaren Engineering Group
530 Chestnut Ridge Road
Woodcliff Lake, NJ 07677

EXISTING SITE PLAN

IN: HUDSON RIVER
AT: HOBOKEN
COUNTY OF: HOBOKEN STATE: NJ

SHT OF 09 03/15/2024

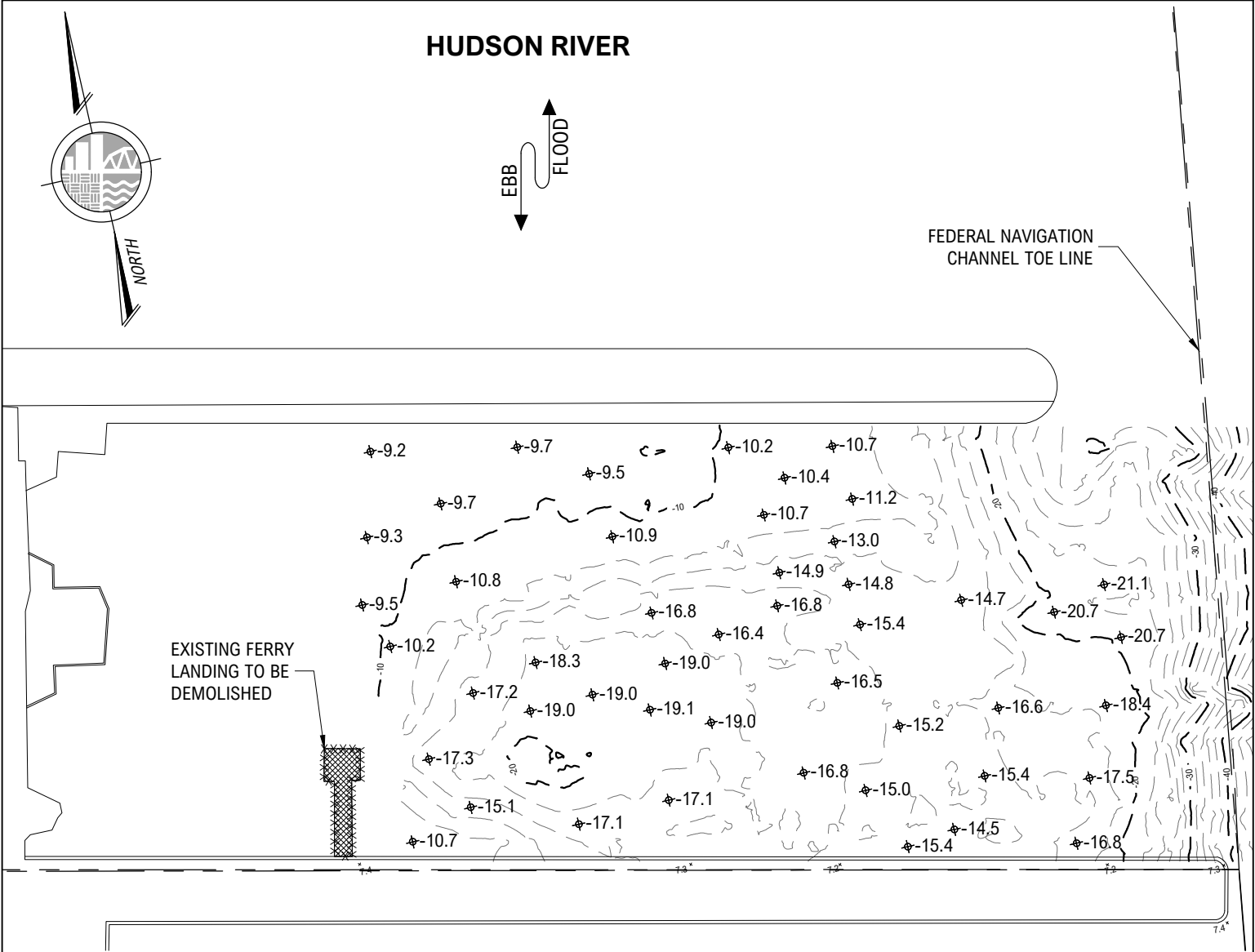

NOTES:

- 1. THE INFORMATION PRESENTED ON THIS DRAWING REPRESENTS THE RESULTS OF THE FIELD SURVEY PERFORMED ON JANUARY 17, 2024 AND CAN ONLY BE CONSIDERED AS THE GENERAL CONDITIONS AT THE TIME OF THE SURVEY.
- 2. HYDROGRAPHIC SURVEY DATA WAS COLLECTED WITH A SONARMITE HYDROLITE-TM SINGLE BEAM ECHOSOUNDER AND A TRIMBLE R8 GNSS. DATA PROCESSED WITH AUTODESK CIV3D.
- 3. COORDINATE SYSTEM: NAD83 NEW JERSEY STATE PLANE FT
- 4. VERTICAL DATUM: NORTH AMERICAN VERTICAL DATUM OF 1988 (NAV88) FT

LEGEND:

- — — MAJOR CONTOUR
- - - MINOR CONTOUR
- ⊕ 0.00 SPOT ELEVATION
- XXXXXXXXX DEMOLITION AREA

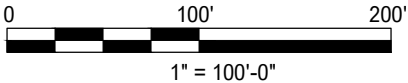

PURPOSE: FERRY LANDING BARGE REPLACEMENT

DATUM: NAVD88

ADJACENT OWNERS:
1. SEE ATTACHED LIST.

HOBOKEN 14TH ST FERRY
LANDING BARGE REPLACEMENT

APPLICANT: DONALD LILOIA
4800 AVENUE AT PORT IMPERIAL
WEEHAWKEN, NJ 07086

AGENT: M.G. McLaren Engineering Group
530 Chestnut Ridge Road
Woodcliff Lake, NJ 07677

DEMOLITION PLAN

IN: HUDSON RIVER
AT: HOBOKEN
COUNTY OF: HOBOKEN STATE: NJ

SHT OF 09 03/15/2024

[illegible]

1. THE INFORMATION PRESENTED ON THIS DRAWING REPRESENTS THE RESULTS OF THE FIELD SURVEY PERFORMED ON JANUARY 17, 2024 AND CAN ONLY BE CONSIDERED AS THE GENERAL CONDITIONS AT THE TIME OF THE SURVEY.
2. HYDROGRAPHIC SURVEY DATA WAS COLLECTED WITH A SONAR MITE HYDROLITE-TM SINGLE BEAM ECHOSOUNDER AND A TRIMBLE R8 GNSS. DATA PROCESSED WITH AUTODESK CIV3D.
3. COORDINATE SYSTEM: NAD83 NEW JERSEY STATE PLANE FT
4. VERTICAL DATUM: NORTH AMERICAN VERTICAL DATUM OF 1988 (NAV88) FT

— — — MAJOR CONTOUR
 - - - MINOR CONTOUR
 ⊕ 0.00 SPOT ELEVATION

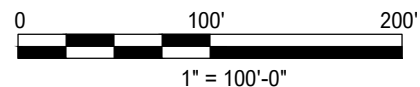

SHT OF 09 03/15/2024

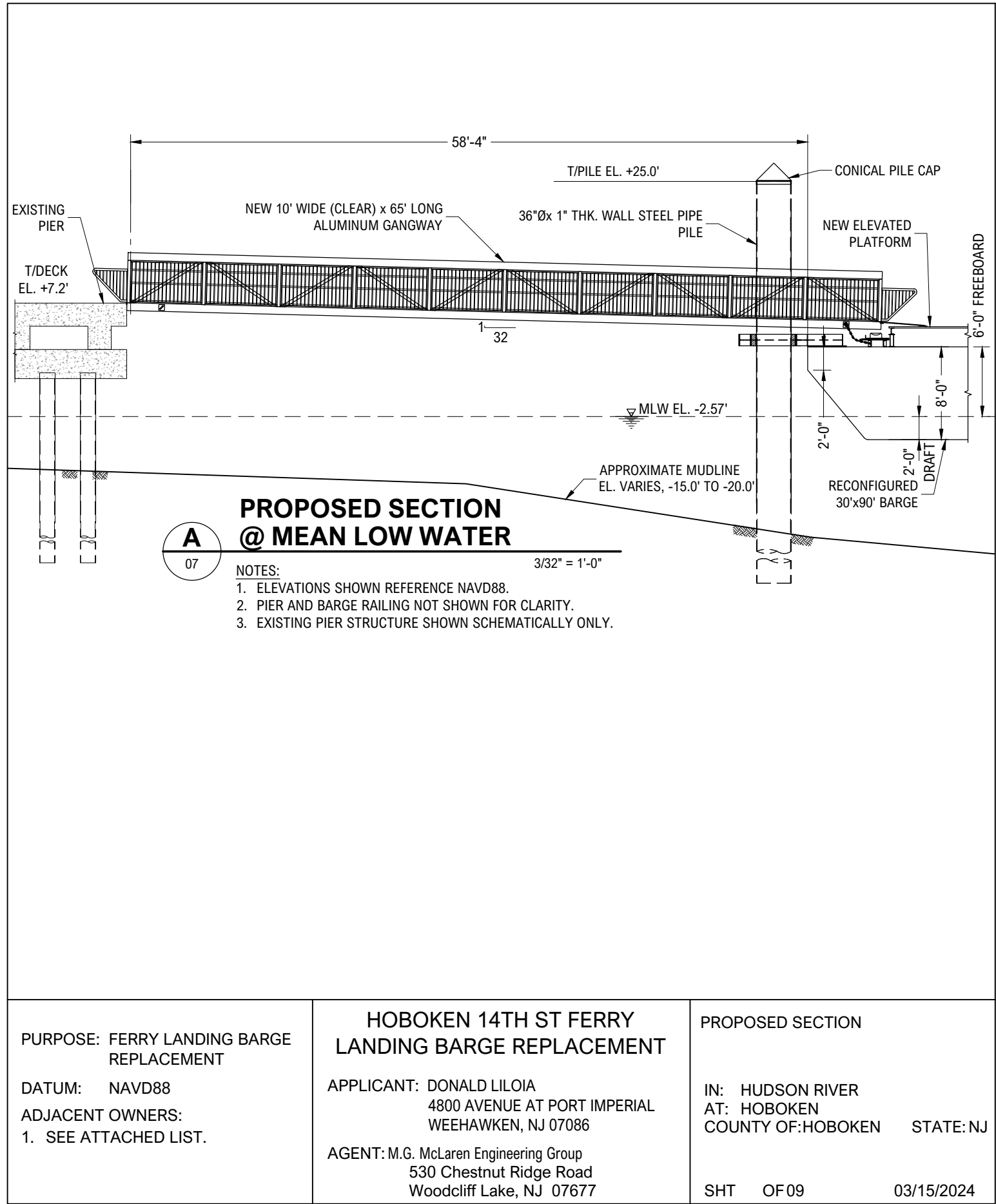

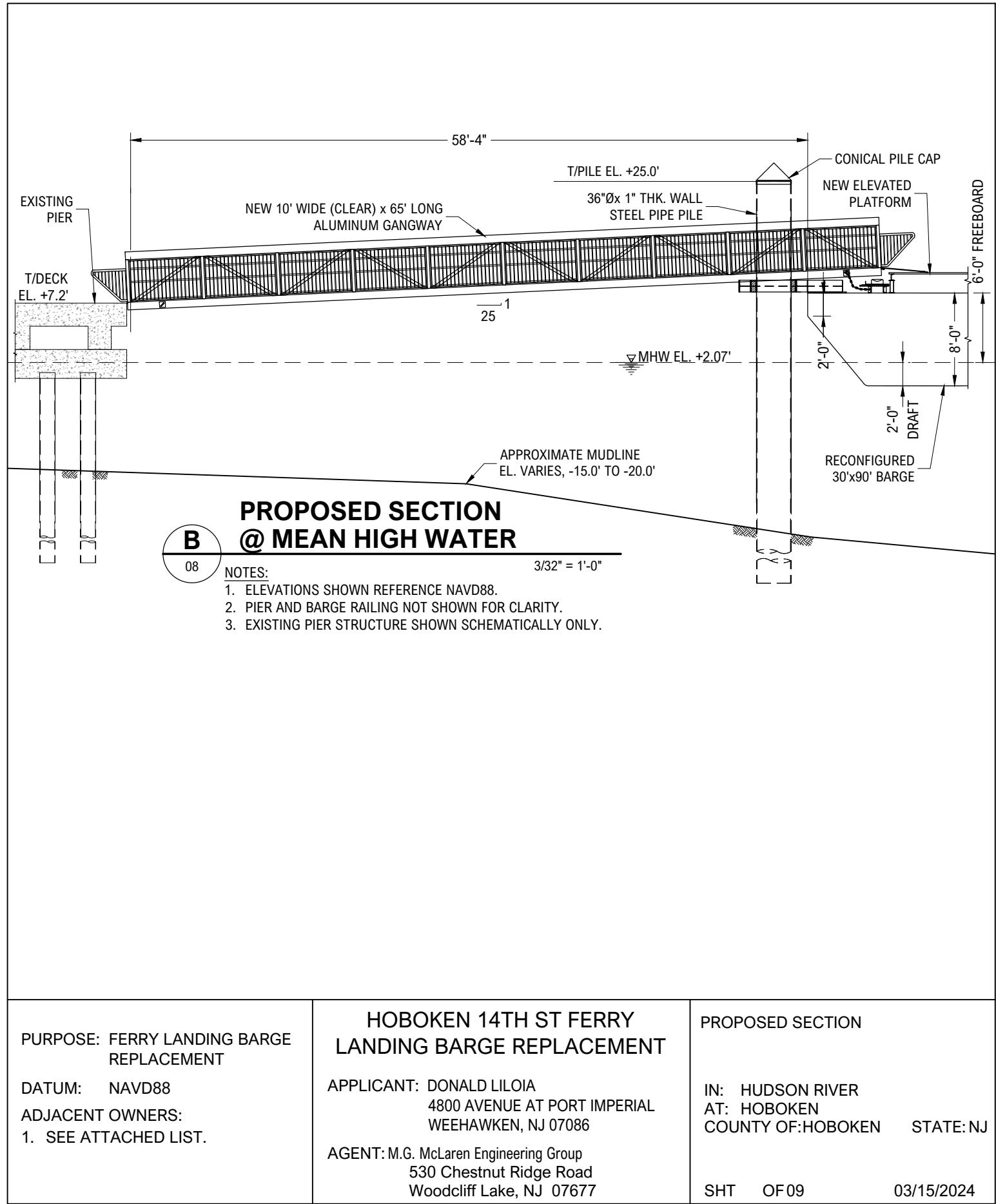

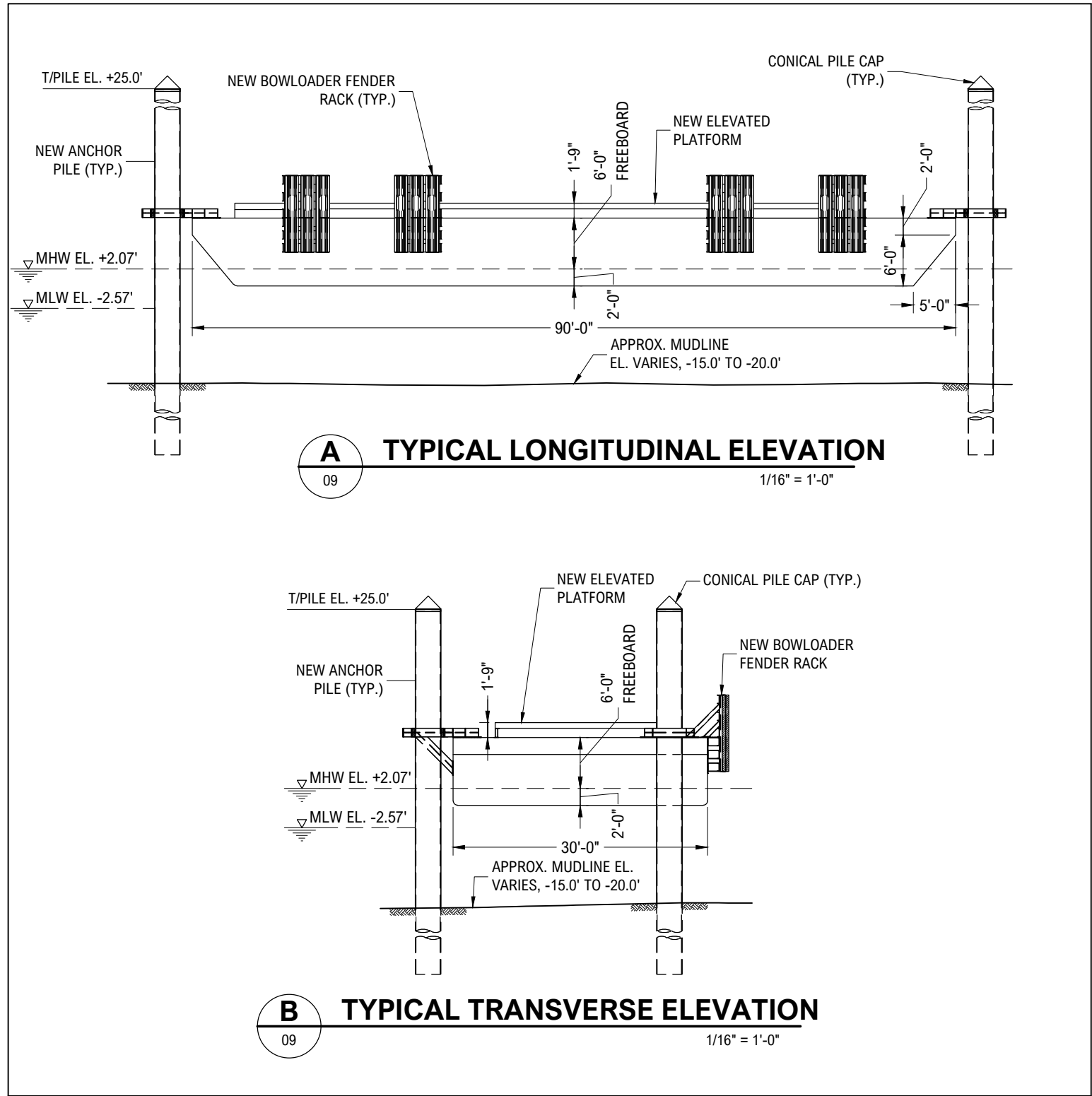

<p>PURPOSE: FERRY LANDING BARGE REPLACEMENT</p> <p>DATUM: NAVD88</p> <p>ADJACENT OWNERS:</p> <p>1. SEE ATTACHED LIST.</p>	<p>HOBOKEN 14TH ST FERRY LANDING BARGE REPLACEMENT</p> <p>APPLICANT: DONALD LILOIA 4800 AVENUE AT PORT IMPERIAL WEEHAWKEN, NJ 07086</p> <p>AGENT: M.G. McLaren Engineering Group 530 Chestnut Ridge Road Woodcliff Lake, NJ 07677</p>	<p>BARGE ELEVATIONS</p> <p>IN: HUDSON RIVER AT: HOBOKEN COUNTY OF: HOBOKEN STATE: NJ</p> <p>SHT OF 09 03/15/2024</p>
---	---	--